

KIT JANELA DE CORRER - 2 FOLHAS

FECHO BATE-FECHA MINI V/A

AL 1571 P 2 PÇ

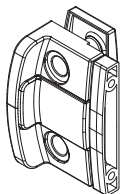

ACABAMENTO ALV. INFERIOR DIREITA

AC MS 27 AD 1 PÇ

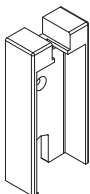

ACABAMENTO ALV. INFERIOR ESQUERDA

AC MS 27 AE 1 PÇ

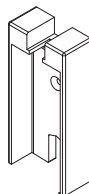

ACABAMENTO LEITO ALVENARIA

AC MS 29 B 2 PÇ

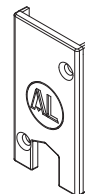

ACABAMENTO LEITO ESCOVINHA DIREITO

AC MS 24 D 2 PÇ

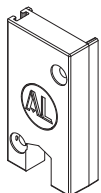

ACABAMENTO LEITO ESCOVINHA ESQUERDO

AC MS 24 E 2 PÇ

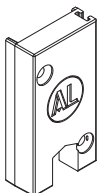

ACABAMENTO MA DIREITO

AC MS 22 D 2 PÇ

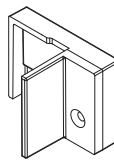

ACABAMENTO MA ESQUERDO

AC MS 22 E 2 PÇ

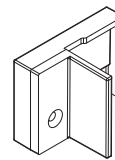

ROLDANA SIMPLES JANELA

ROL JA 1739 4 PÇ

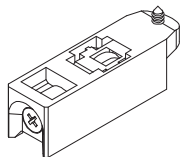

OBS: CARGA MÁXIMA 20kg

PERFIL TRILHO SUP DUPLO JANELA

EST-039 1 PÇ

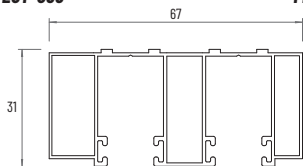

PERFIL LEITO INF 6mm JANELA

EST-045 1 PÇ

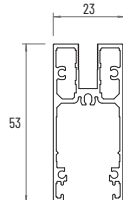

PERFIL TRILHO INF DUPLO PRINC JANELA

EST-037 1 PÇ

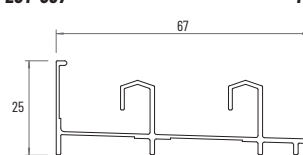

PERFIL CLICK ACABAMENTO JANELA

EST-021N 2 PÇ



PERFIL LATERAL PRINCIPAL

EST-022 2 PÇ

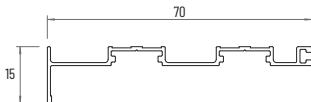

PERFIL LATERAL ACABAMENTO 2 FOLHAS

EST-030 2 PÇ



PERFIL MA 6mm

EST-041 2 PÇ

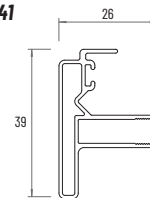

PERFIL U ACABAMENTO JANELA

EST-052N 2 PÇ

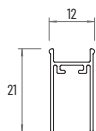

DETALHES TÉCNICOS JANELA DE CORRER - 2 FOLHAS

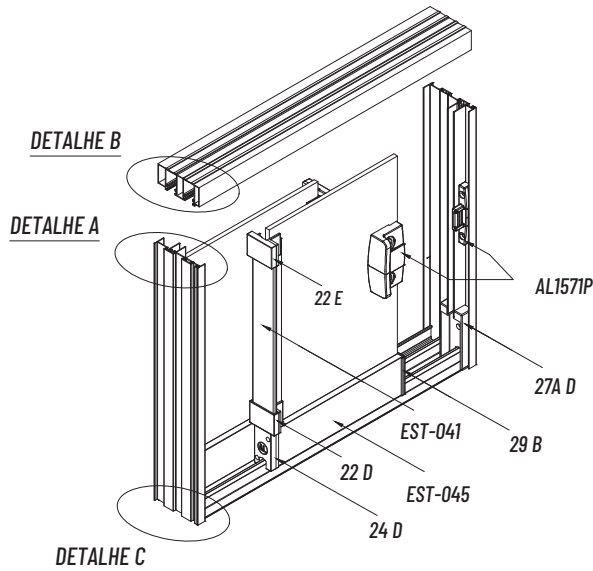

DETALHE A

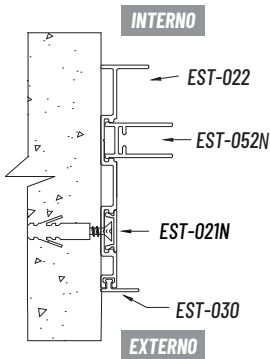

DETALHE B

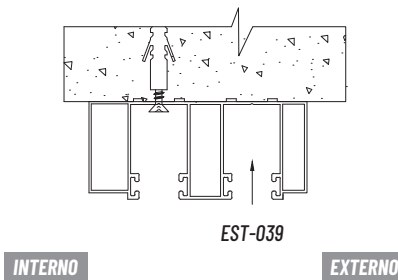

DETALHE C

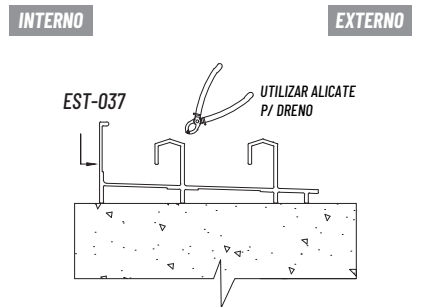

VÃO = 1.000mm
 NA ALTURA, OS VIDROS SERÃO:
 O MAIOR LADO DO VÃO MENOS 70mm

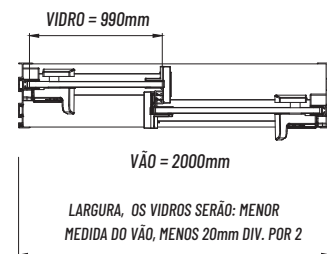
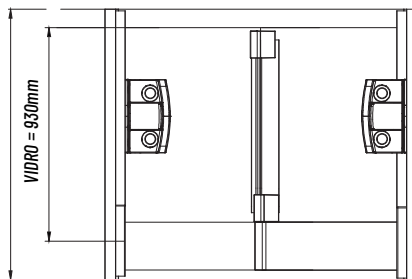

IMPORTANTE:

- INTERFERÊNCIA MÁXIMA DO VÃO EM RELAÇÃO AO DESNÍVEL E PRUMO SÃO: ALTURA -15mm, LARGURA -10mm;
- CARGA MÁXIMA POR FOLHA: SPL 40kg (UTILIZANDO 2 ROLDANAS);
- POR PEÇA VIDRO 06mm: ALTURA MÁXIMA 2000mm E LARGURA 1200mm

KIT JANELA DE CORRER - 3 FOLHAS

FECHO BATE-FECHA MINI V/A

AL 1571 P 2 PÇ

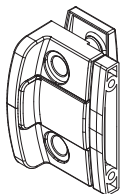

ACABAMENTO ALV. INFERIOR DIREITA

AC MS 27 AD 1 PÇ

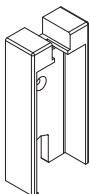

ACABAMENTO ALV. INFERIOR ESQUERDA

AC MS 27 AE 1 PÇ

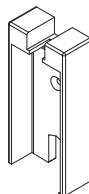

ACABAMENTO LEITO ALVENARIA

AC MS 29 B 2 PÇ

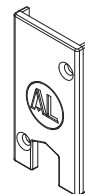

ACABAMENTO LEITO ESCOVINHA DIREITO

AC MS 24 D 4 PÇ

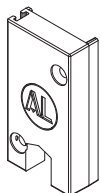

ACABAMENTO LEITO ESCOVINHA ESQUERDO

AC MS 24 E 4 PÇ

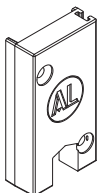

ACABAMENTO MA DIREITO

AC MS 22 D 4 PÇ

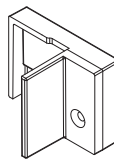

ACABAMENTO MA ESQUERDO

AC MS 22 E 4 PÇ

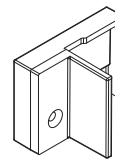

ROLDANA SIMPLES JANELA

ROL JA 1739 6 PÇ

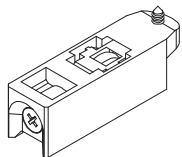

OBS: CARGA MÁXIMA 20kg

PERFIL TRILHO SUP SIMPLES JANELA

EST-027 1 PÇ

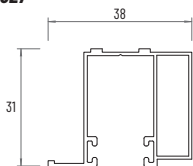

PERFIL TRILHO SUP DUPLO JANELA

EST-039 1 PÇ

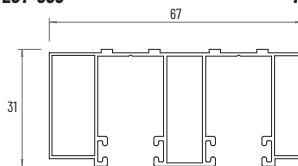

PERFIL LEITO INF 6mm JANELA

EST-045 1 PÇ

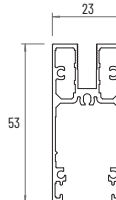

PERFIL TRILHO INF SIMPLES JANELA

EST-025 1 PÇ

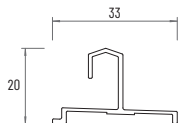

PERFIL TRILHO INF DUPLO PRINC JANELA

EST-037 1 PÇ

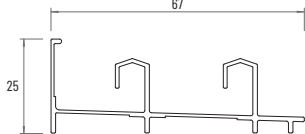

PERFIL CLICK ACABAMENTO JANELA

EST-021N 4 PÇ



PERFIL LATERAL PRINCIPAL

EST-022 2 PÇ

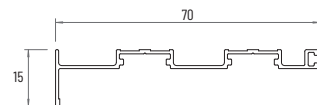

PERFIL LATERAL ACABAMENTO 3 FOLHAS

EST-023 2 PÇ

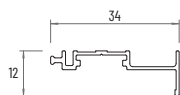

PERFIL MA 6mm

EST-041 4 PÇ

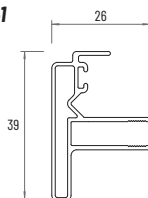

PERFIL U ACABAMENTO JANELA

EST-052N 2 PÇ

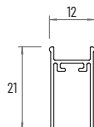

DETALHES TÉCNICOS JANELA DE CORRER - 3 FOLHAS

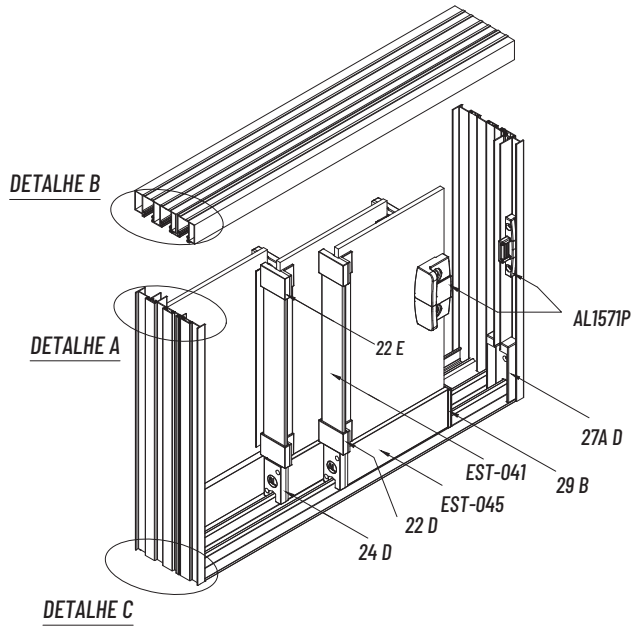

DETALHE A

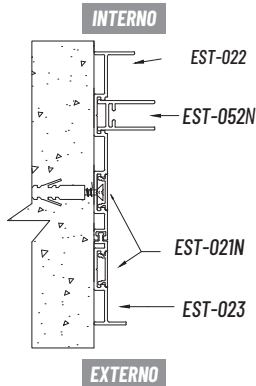

DETALHE B

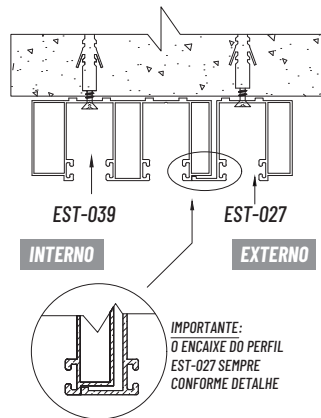

DETALHE C

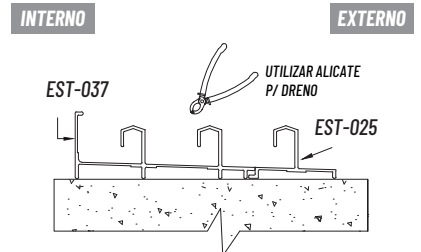

VÃO = 1.000mm
 NA ALTURA, OS VIDROS SERÃO:
 O MAIOR LADO DO VÃO MENOS 70mm

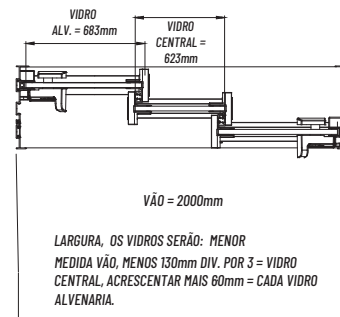
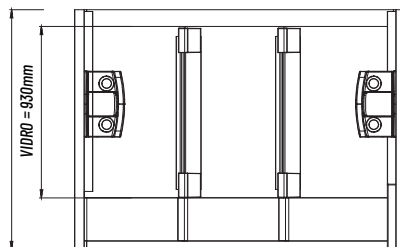

LARGURA, OS VIDROS SERÃO: MENOR
 MEDIDA VÃO, MENOS 130mm DIV. POR 3 = VIDRO
 CENTRAL, ACRESCENTAR MAIS 60mm = CADA VIDRO
 ALVENARIA.

IMPORTANTE:

- INTERFERÊNCIA MÁXIMA DO VÃO EM RELAÇÃO AO DESNÍVEL E PRUMO SÃO: ALTURA -15mm, LARGURA -10mm;
- CARGA MÁXIMA POR FOLHA: SPL 40kg (UTILIZANDO 2 ROLDANAS);
- POR PEÇA VIDRO 06mm: ALTURA MÁXIMA 2000mm E LARGURA 1200mm

KIT JANELA DE CORRER - 4 FOLHAS

FECHO BATE-FECHA MINI V/A

AL 1571 P 2 PÇ

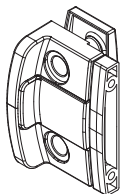

ACABAMENTO ALV. INFERIOR DIREITA

AC MS 27 AD 1 PÇ

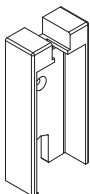

ACABAMENTO ALV. INFERIOR ESQUERDA

AC MS 27 AE 1 PÇ

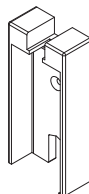

ACABAMENTO LEITO ALVENARIA

AC MS 29 B 2 PÇ



ACABAMENTO LEITO ESCOVINHA DIREITO

AC MS 24 D 6 PÇ

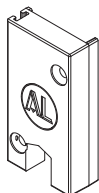

ACABAMENTO LEITO ESCOVINHA ESQUERDO

AC MS 24 E 6 PÇ



ACABAMENTO MA DIREITO

AC MS 22 D 6 PÇ

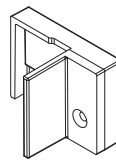

ACABAMENTO MA ESQUERDO

AC MS 22 E 6 PÇ

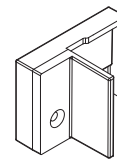

ROLDANA SIMPLES JANELA

ROL JA 1739 8 PÇ

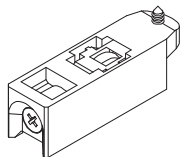

OBS: CARGA MÁXIMA 20kg

PERFIL TRILHO SUP SIMPLES JANELA

EST-027 2 PÇ

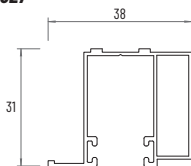

PERFIL TRILHO SUP DUPLO JANELA

EST-039 1 PÇ

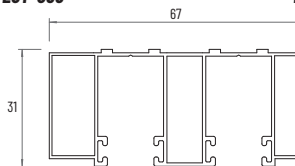

PERFIL LEITO INF 6mm JANELA

EST-045 1 PÇ

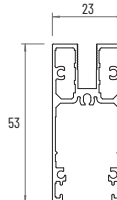

PERFIL TRILHO INF DUPLO PRINC JANELA

EST-037 1 PÇ

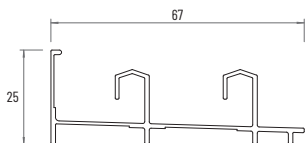

PERFIL TRILHO INF DUPLO JANELA

EST-038N 1 PÇ

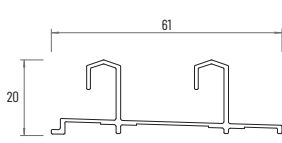

PERFIL LATERAL PRINCIPAL

EST-021N 4 PÇ



PERFIL LATERAL PRINCIPAL

EST-022 2 PÇ

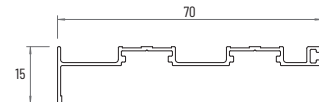

PERFIL LATERAL ACABAMENTO 4 FOLHAS

EST-036 2 PÇ

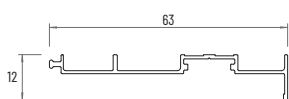

PERFIL MA 6mm

EST-041 6 PÇ

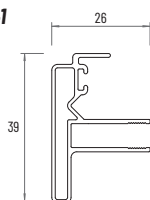

PERFIL U ACABAMENTO JANELA

EST-052N 2 PÇ

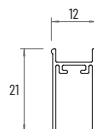

DETALHES TÉCNICOS JANELA DE CORRER - 4 FOLHAS

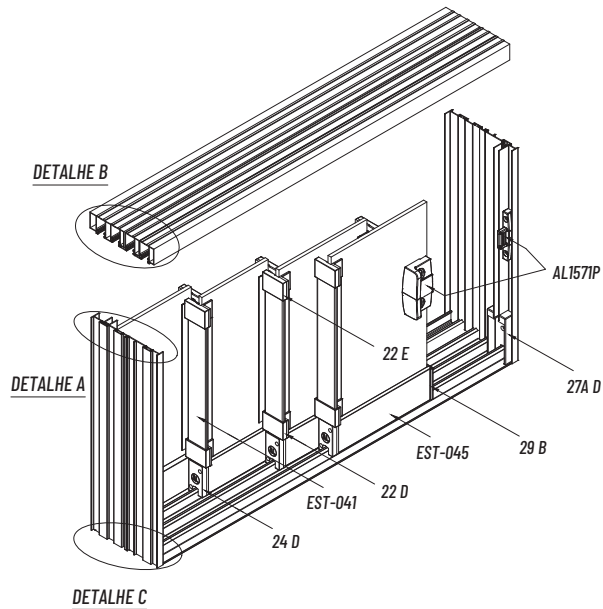

DETALHE A

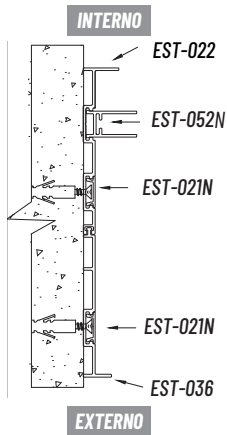

DETALHE B

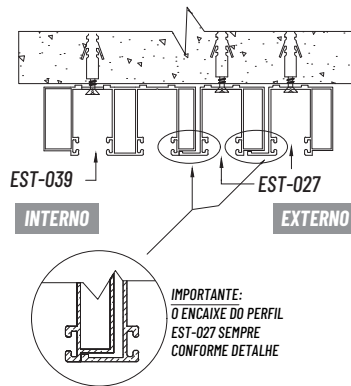

DETALHE C

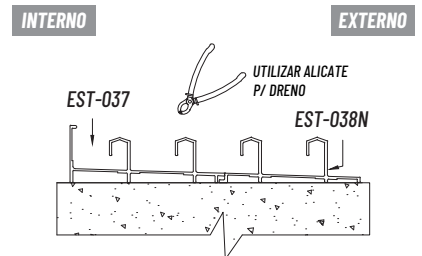

VÃO = 1.000mm

NA ALTURA, OS VIDROS SERÃO:
O MAIOR LADO DO VÃO MENOS 70mm

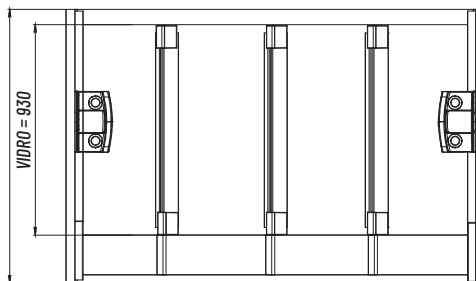

VIDRO CENTRAL =
470mm

VIDRO
ALV. = 530mm

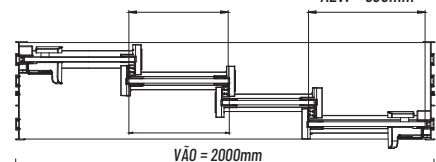

LARGURA, OS VIDROS SERÃO: MENOR MEDIDA VÃO
MENOS 120mm DIV. POR 4 = VIDROS CENTRAIS, ACRESCENTAR 60mm
EM CADA VIDRO ALVENARIA.

IMPORTANTE:

- INTERFERÊNCIA MÁXIMA DO VÃO EM RELAÇÃO AO DESNÍVEL E PRUMO SÃO: ALTURA -15mm, LARGURA -10mm;
- CARGA MÁXIMA POR FOLHA: SPL 40kg (UTILIZANDO 2 ROLDANAS);
- POR PEÇA VIDRO 06mm: ALTURA MÁXIMA 2000mm E LARGURA 1200mm